

About

This type of cooling counter has a glass extension and a cooling tub for small GN containers. The three middle drawers are cooled and the rest are neutral. There is a cutout in the top plate for your heating device.

It is suitable for restaurants, fast food, hotels, hospitals, or canteens. Made of stainless steel, so it is easy to clean and guarantees long life.

Technical drawing

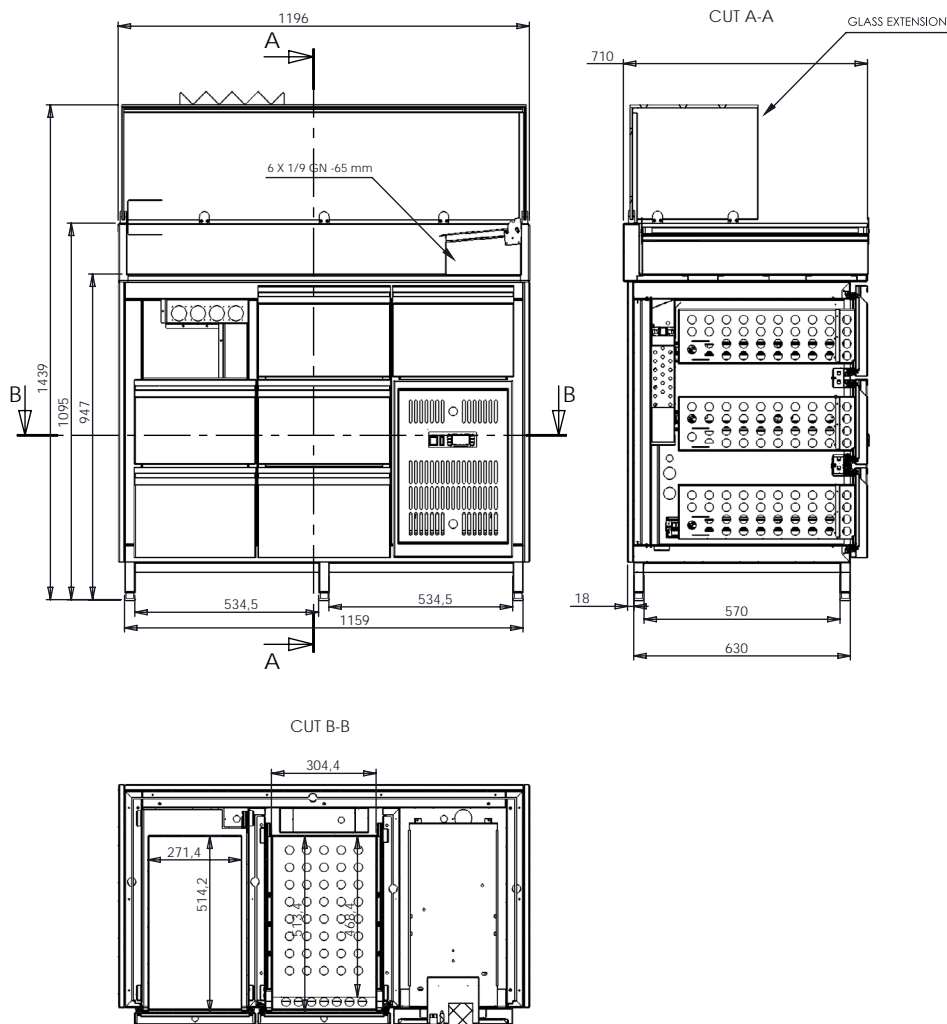

Illustrative pictures



Specification list

Outside dimension:	
Width (x) [mm]	1196
Depth (y) [mm]	710
Height (z) [mm]	1439
Temperature	+3°C ~ +8°C
Cooling medium	R290
Refr. capacity (evap. @ -10°C)	0,42kW
Voltage	1, N, PE ~ 230V, 50Hz
Power input	0,7kW
Current draw	1,3A

With aggregate

Model	Order number	Price
Cooling sausage counter, drawers, 3 sides stainless steel	V1-030608-0001	
Cooling sausage counter, drawers, 3 sides galvanized	V1-030608-0002	

central cooled

Model	Order number	Price
Cooling sausage counter, drawers, 3 sides stainless steel	V1-030608-0003	
Cooling sausage counter, drawers, 3 sides galvanized	V1-030608-0004	

** The evaporation tub is not included as a standard part of the product; it must be specified when placing the order.