

# 04 Showcase DE - for baking trays

Technical drawing

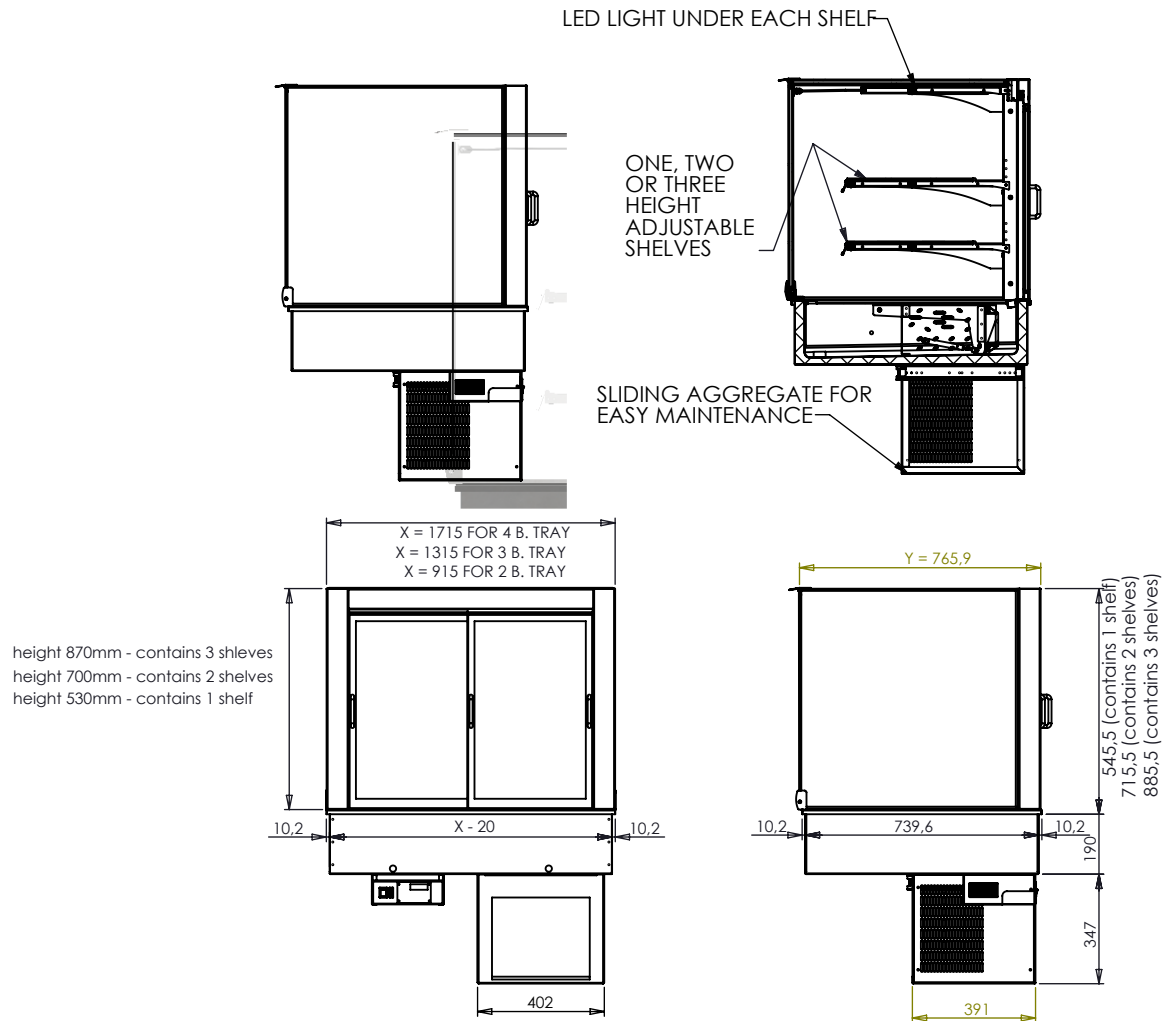



SHOWCASE FOR BAKING TRAY 600X400

Renders





## Showcase DE - for baking trays



## SPECIFICATION LIST FOR TOTAL HEIGHT 1083mm

	SELF CONTAINED	2EN	3EN	4EN
<b>Outside dimension:</b>				
	Width (x) [mm]	915	1315	1715
	Depth (y) [mm]	766	766	766
	Height (z) [mm]		1083	
<b>Number of shelves</b>			1x	
	Temperatures		+5°C ~ +8°C	
	Cooling medium		R290	
	Refr. capacity (evap. @ -10°C)	0,65kW	0,9kW	1,1kW
	Voltage		1, N, PE ~ 230V, 50Hz	
	Power input	0,5kW	0,75kW	0,9kW
	Material		Stainless Steel	

## SPECIFICATION LIST FOR TOTAL HEIGHT 1253mm

	SELF CONTAINED	2EN	3EN	4EN
<b>Outside dimension:</b>				
	Width (x) [mm]	915	1315	1715
	Depth (y) [mm]	766	766	766
	Height (z) [mm]		1253	
<b>Number of shelves:</b>			2x	
	Temperatures		+5°C ~ +8°C	
	Cooling medium		R290	
	Refr. capacity (evap. @ -10°C)	0,9kW	1,1kW	1,2kW
	Voltage		1, N, PE ~ 230V, 50Hz	
	Power input	0,75kW	0,9kW	0,95kW
	Material		Stainless Steel	

## SPECIFICATION LIST FOR TOTAL HEIGHT 1423mm

	SELF CONTAINED	2EN	3EN	4EN
<b>Outside dimension:</b>				
	Width (x) [mm]	915	1315	1715
	Depth (y) [mm]	766	766	766
	Height (z) [mm]		1423	
<b>Number of shelves:</b>			3x	
	Temperatures		+5°C ~ +8°C	
	Cooling medium		R290	
	Refr. capacity (evap. @ -10°C)	0,9kW	1,1kW	1,2kW
	Voltage		1, N, PE ~ 230V, 50Hz	
	Power input	0,75kW	0,9kW	0,95kW
	Material		Stainless Steel	